

SELF-ALIGNING TELESCOPIC SYSTEM



Order codes
TELERACE
TLRS80-0380
 Left side telescopic rail, size 73mm, stroke 380mm
TLRD116-0700
 Right side telescopic rail, size 108mm, stroke 700mm

COMPENSATION OF ASSEMBLING/SURFACE ERRORS

TELERACE

The TLR and TLQ rails are the world's only telescopic rail system which incorporates self-aligning feature to absorb parallelism errors of the mounting surfaces.
 The TLR telescopic rails are designed for heavy duty High-Tech telescopic applications, with precise motorized movement, requiring constant smooth sliding performance with no play. The special smooth operating performance is due to double-row precision bearings, strong rails with hardened and honed raceways, fixed to a rigid intermediate S-shaped steel plate, assuring high load capacities and low deflexion at even fully extended position.
 The TLR telescopic rails assure unique self-aligning capability, when used in pairs.

The right telescopic rail TLRD, allows the RA-like-sliders to rotate with no play, in the lower rail-element to compensate for surface misalignments, while the rigid left TLRS telescopic rail, maintains a stable and precise extension.
 TLR system offers unique possibilities and benefits for all kind of automation applications with variable telescopic strokes, which until now have been troubled by common friction and breakdown problems, during the ball-cage rephasing when using of old-type ball-cage telescopic rails.
 To assure max. load capacity the telescopic rail must be correctly positioned according to the rollers' positioning, - which are non-symmetric and with different position in upper - lower rail element.

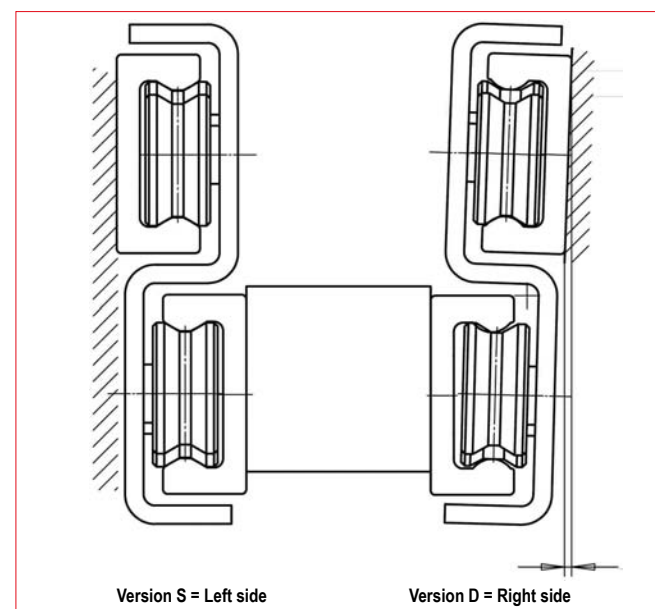
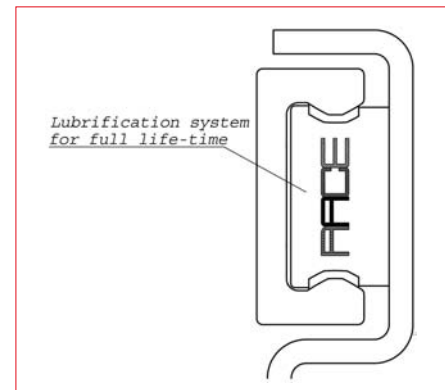

Therefore the extended part must always be fixed to the lower rail, which is identified by the letter B.
 All TELERACE telescopic rails guarantee maintenance free operation, thanks to strong raceway wipers and longitudinal seals for dust and impurity protection, and an integrated lubef for-life greasing system, assuring a constant thin layer of lubrication on the raceway surfaces.

All TELERACE telescopic rails are equipped with internal end-stops, only designed to drag the intermediate element. It is therefore highly recommended not to use these internal end- of stroke travel limits as functional terminals; strong external end-stops must be added.
 The TELERACE's load capacities are intended at half extension (L/2) as indicated in by letter "P" in below drawing. Unlike ball-cages drawer slides, the TELERACE max. load capacities are based on continuously non-stop operation.

Therefore a straight load comparison with other telescopic rails isn't possible, as these load capacities are merely a static load capacity, based on low daily frequency.
 To offer a wide range of load capacities and extensions, the TLR telescopic rails come in 2 dimensions. The TLR.80, based on 28mm rails with outer height of 80mm and TLR.116, based on 43mm rails, with outer height of 116mm. Both rails come with an overall black finish.

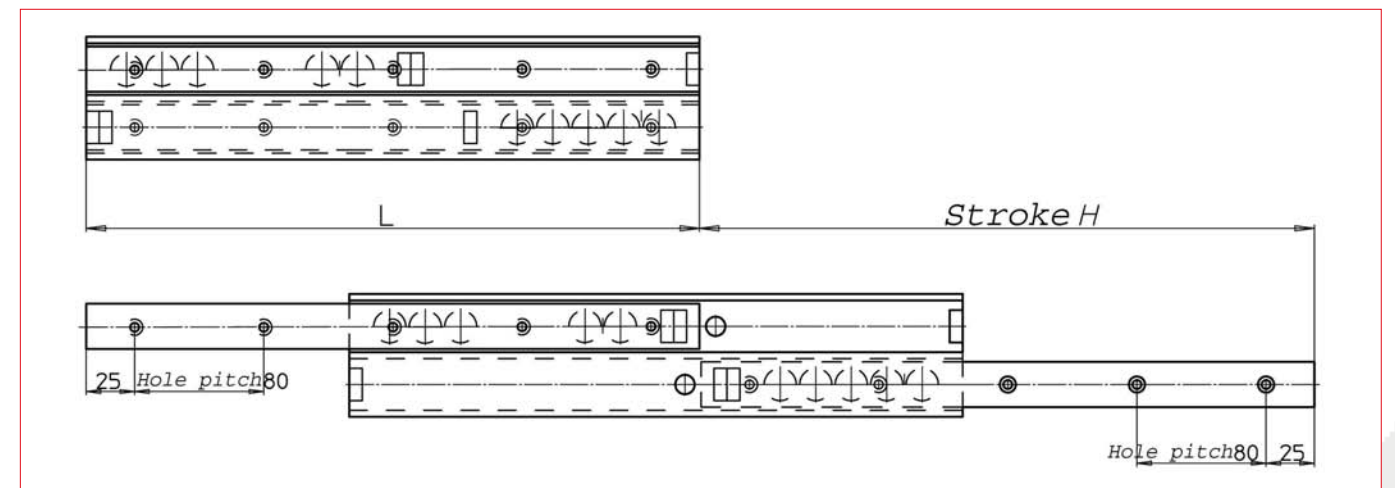
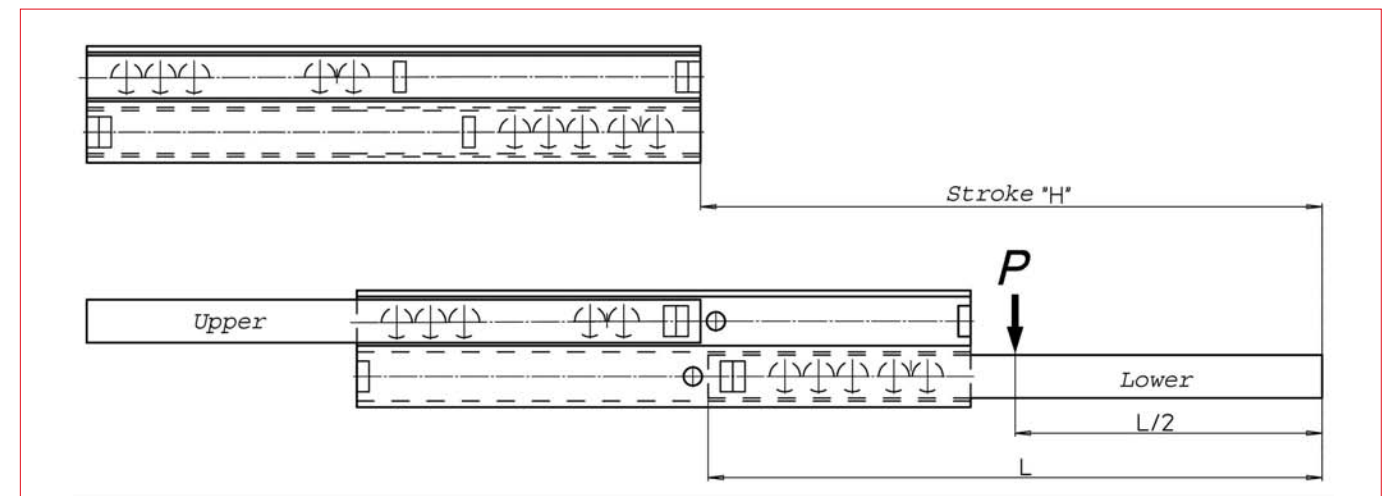

TELESCOPIC RAIL TLR80 SERIES

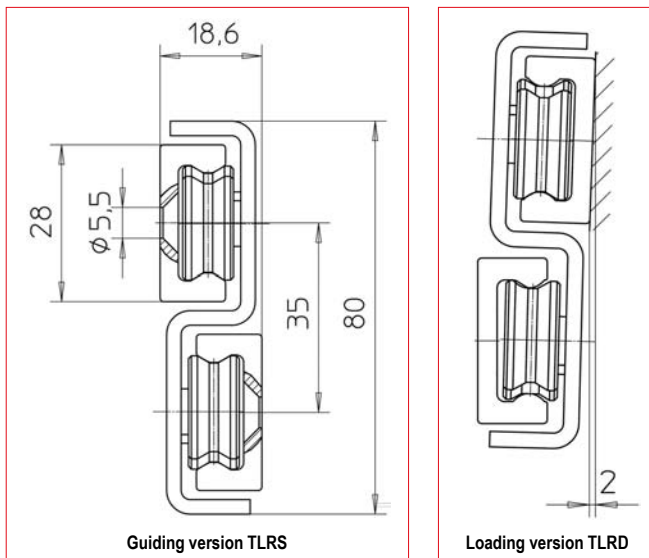

A right (TLRD) version and a left (TLRS) version are available. Must be ordered so, when working in pair.

Type	Stroke H	Length L	Co rad (N)	Kg
TLR.80-0380	380	370	753	2,1
TLR.80-0460	460	450	817	2,5
TLR.80-0540	540	530	1207	2,9
TLR.80-0620	620	610	1495	3,3
TLR.80-0700	700	690	1673	3,7
TLR.80-0780	780	770	1771	4,1
TLR.80-0860	860	850	1755	4,5
TLR.80-0940	940	930	1623	4,9
TLR.80-1020	1020	1010	1510	5,3
TLR.80-1180	1180	1170	1325	6,1
TLR.80-1340	1340	1330	1180	6,9
TLR.80-1500	1500	1490	1064	7,7

TELESCOPIC RAIL TLR116 SERIES

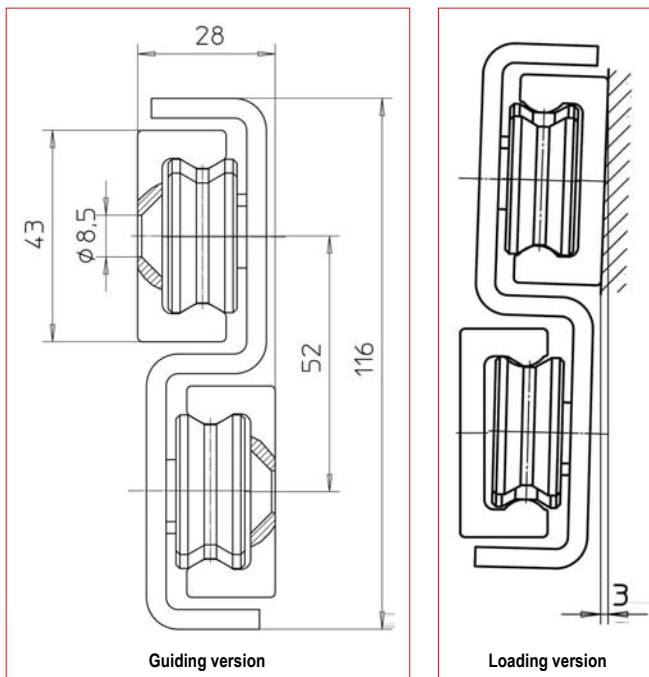

A right (TLRD) version and a left (TLRS) version are available. Must be ordered so, when working in pair.

Type	Stroke H	Length L	Co rad (N)	Kg
TLR.116-0540	540	530	1829	6,4
TLR.116-0620	620	610	2040	7,3
TLR.116-0700	700	690	2870	8,2
TLR.116-0780	780	770	3033	9,1
TLR.116-0860	860	850	3780	10,1
TLR.116-0940	940	930	3978	11,0
TLR.116-1020	1020	1010	4122	11,8
TLR.116-1180	1180	1170	4080	13,6
TLR.116-1340	1340	1330	3648	15,4
TLR.116-1500	1500	1490	3298	17,1
TLR.116-1660	1660	1650	3010	18,9
TLR.116-1820	1820	1810	2768	20,7
TLR.116-1980	1980	1970	2562	22,4

TLQ TELERACE: COMPACT TELESCOPIC SYSTEM



The very compact TLQ telescopic rails are designed for High-Tech telescopic applications with precise motorized movement, requiring constant smooth sliding performance with no play.

The squared design is obtained by using two MR-rails with hardened honed raceways, as the rigid intermediate element, into which the sliders are assembled. The TLQ telescopic rails offer both high radial and axial load capacities.

The rail/slider configuration allows the TLQ telescopic rails to be mounted not only at the side, but also underneath the moving part, when there are space limitations at the sides, or to be used in typical vertical applications. See below tables and figures.

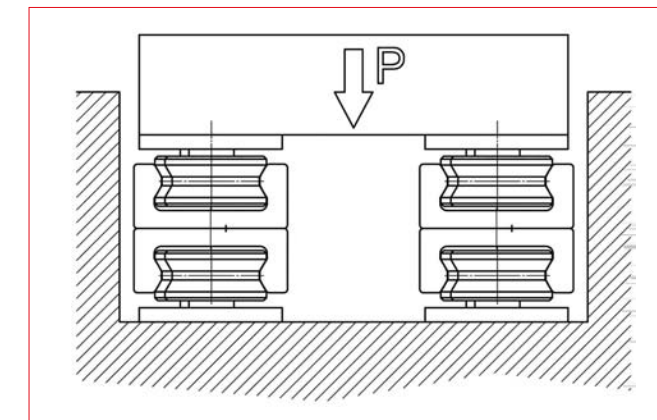
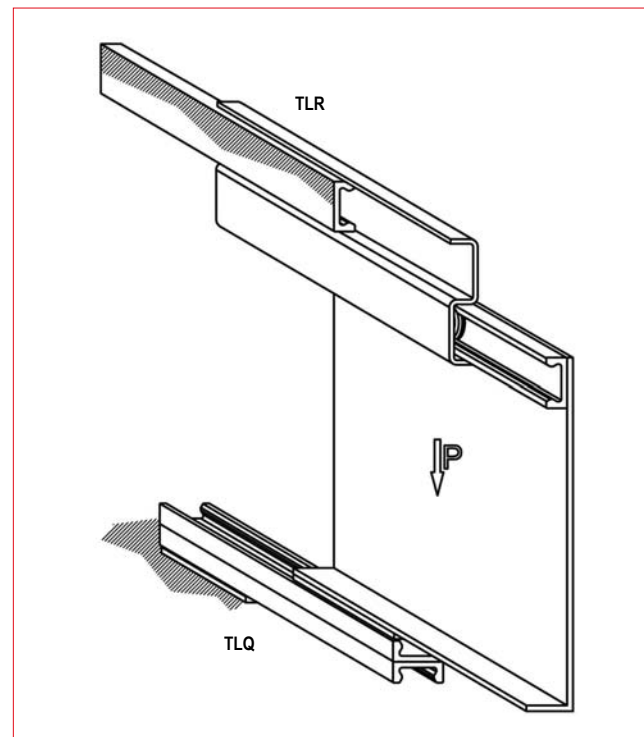
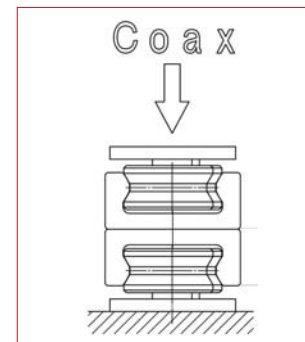
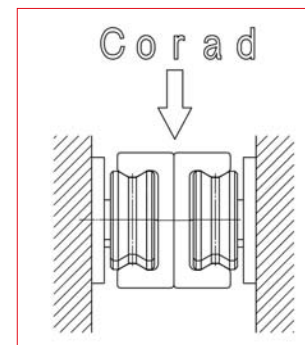

In the case of horizontal panel extension, we recommend the use of a pair of TLR and TLQ, as the TLR can absorb some lateral structural misalignments on the vertical axis. TLQ system assures smooth extension for all kinds of automation applications with variable telescopic strokes, which until now have been troubled by common friction breakdown problems, during the ball-cage rephasing, when using typical drawer slides. Same rephase problem or even deformation of the ball-cages, occurs for all vertical applications, as the ball-cage in such telescopic rails, constantly tend to move downwards, so extra friction is generated with each stroke, during the repositioning of the ball-cages.

To assure max. load capacity the telescopic rails must be correctly orientation, assembled. The extended part must always be fixed to the shortest slider, identified by the letter B.

Order codes
TELESCOPIC RAILS
TLQD37-0460
 Compact Telescopic rail,
 size 37mm,
 stroke 460mm
TLQS57-1180
 Compact Telescopic rail,
 size 57mm,
 stroke 1180mm

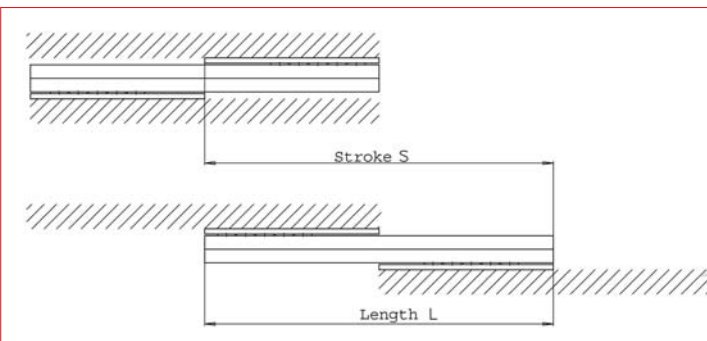

TELESCOPIC RAIL TLQ37 SERIES

TLQ37-S C'sunk version.
To be used when fixing support (for fixed slider) is with threaded holes.

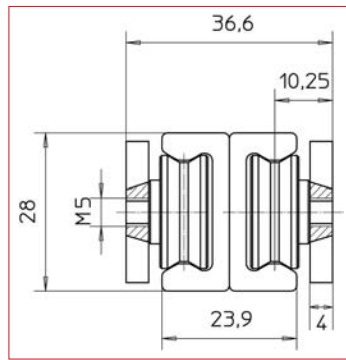
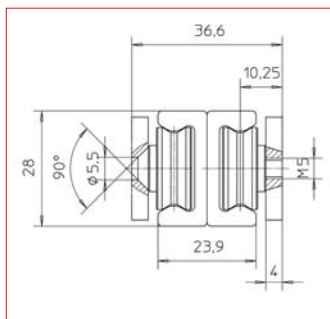

TLQ37-F Threaded version.
To be used when fixing support (for fixed slider) is without threaded holes.

Mobile Slider | Fixed Slider

A right (TLQD) version and a left (TLQS) version are available. Must be ordered so, when working in pair

Type	Stroke	A	B	C	X	M	N	P	R	Q	K	T	Y	F	H	S	L	Z	Corad (N)	Coax (N)	Kg
TLQ.37-0380	380	370	170	201	53	70	70						25	70	50			50	707	441	1,5
TLQ.37-0460	460	450	175	276	53	72	72	72					25	70	55			55	1003	655	1,7
TLQ.37-0540	540	530	207	324	53	88	88	88					23,5	80	80			80	1128	721	2,0
TLQ.37-0620	620	610	239	372	53	104	104	104					24,5	95	95			95	1116	689	2,3
TLQ.37-0700	700	690	271	420	53	120	120	120					25,5	110	110			110	1012	623	2,6
TLQ.37-0780	780	770	303	468	53	102	102	102	102				24	85	85	85		85	926	569	2,8
TLQ.37-0860	860	850	335	516	53	90	90	90	90	96			25	95	95	95		95	853	523	3,1
TLQ.37-0940	940	930	367	564	53	100	100	100	100	100			26	105	105	105		106	791	484	3,4
TLQ.37-1020	1020	1010	399	612	53	110	110	110	110	110			25,5	87	87	87	87	87	738	451	3,6
TLQ.37-1180	1180	1170	463	708	53	108	108	108	108	108	108		25,5	103	103	103	103	103	650	396	4,2
TLQ.37-1340	1340	1330	527	804	53	124	124	124	124	124	124		23,5	120	120	120	120	120	580	353	4,7
TLQ.37-1500	1500	1490	591	900	53	120	120	120	120	120	120	120	25,5	108	108	108	108	108	524	319	5,2

TELESCOPIC RAIL TLQ57 SERIES

TLQ57-S C'sunk version.
To be used when fixing support (for fixed slider) is with threaded holes.

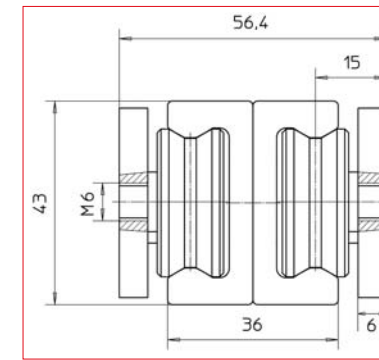
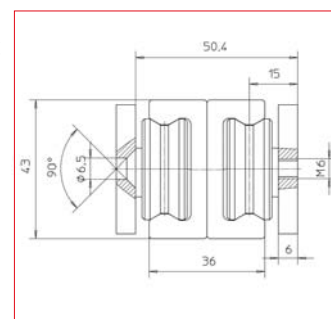

TLQ57-F Threaded version.
To be used when fixing support (for fixed slider) is without threaded holes.

Mobile Slider | Fixed Slider

A right (TLQD) version and a left (TLQS) version are available. Must be ordered so, when working in pair

Type	Stroke	A	B	C	X	M	P	N	R	Q	K	T	V	Y	F	H	S	L	G	Z	Corad (N)	Coax (N)	Kg
TLQ.57-0540	540	530	227	306	61	118		118						28,5	100	70				70	2160	1728	4,8
TLQ.57-0620	620	610	238	375	61	105	100	100						28	102	80				80	2610	2138	5,4
TLQ.57-0700	700	690	270	423	61	118	118	118						28	107	107				107	2799	2280	6,0
TLQ.57-0780	780	770	302	471	61	100	100	100	100					28	123	123				123	2943	2390	6,7
TLQ.57-0860	860	850	334	519	61	116	116	116	102					28	102	88	88			88	2647	2173	7,4
TLQ.57-0940	940	930	366	567	61	120	120	120	136					28,5	103	103	103			103	2460	2016	8,1
TLQ.57-1020	1020	1010	398	615	61	102	102	102	136					28	114	114	114			114	2297	1912	8,7
TLQ.57-1180	1180	1170	462	711	61	126	126	126	126	136				28	102	102	102	100		100	2028	1655	10,0
TLQ.57-1340	1340	1330	526	807	61	120	120	120	120	120	136			28	120	120	120	110		110	1816	1478	11,3
TLQ.57-1500	1500	1490	590	903	61	116	116	116	116	116	136			27,5	107	107	107	107		107	1644	1336	12,5
TLQ.57-1660	1660	1650	654	999	61	132	132	132	132	132	136			27,5	120	120	120	120		119	1501	1219	13,8
TLQ.57-1820	1820	1810	718	1095	61	137	125	125	125	125	125	137		28	112	110	110	110	110	110	1382	1120	15,0
TLQ.57-1980	1980	1970	782	1191	61	140	140	140	140	140	140	140	140	28	121	121	121	121	121	121	1280	1036	16,4

Roller positions: Ex TLQ37 - 0380.

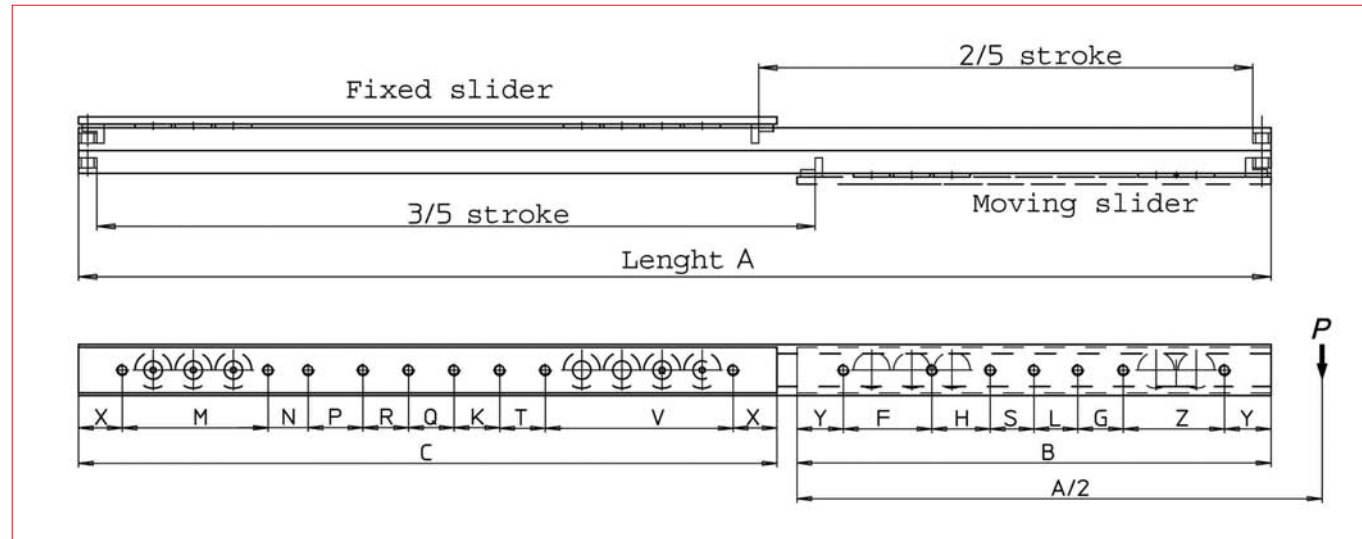
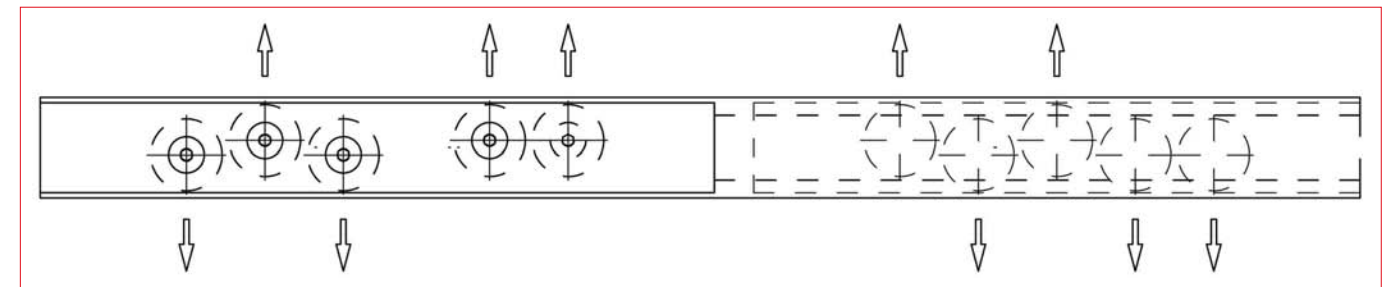

All TELERACE telescopic rails guarantee maintenance free operation, thanks to strong raceway operation, thanks to strong raceway wipers and longitudinal seals for dust and impurity protection, and an integrated lubed for-life greasing system, assuring a constant thin layer of lubrication on the raceway surfaces.

All TELERACE telescopic rails are equipped with internal end-stops, only designed to drag the intermediate element. It is therefore highly recommended not to use these internal end of stroke travel limits as functional terminals; strong external end-stops must be added. Similarly to the TLR series, the TLQ's stroke goes slightly beyond the overall length of the rail in closed position. The rails come with an overall black finish.